

# Cannonball Drop

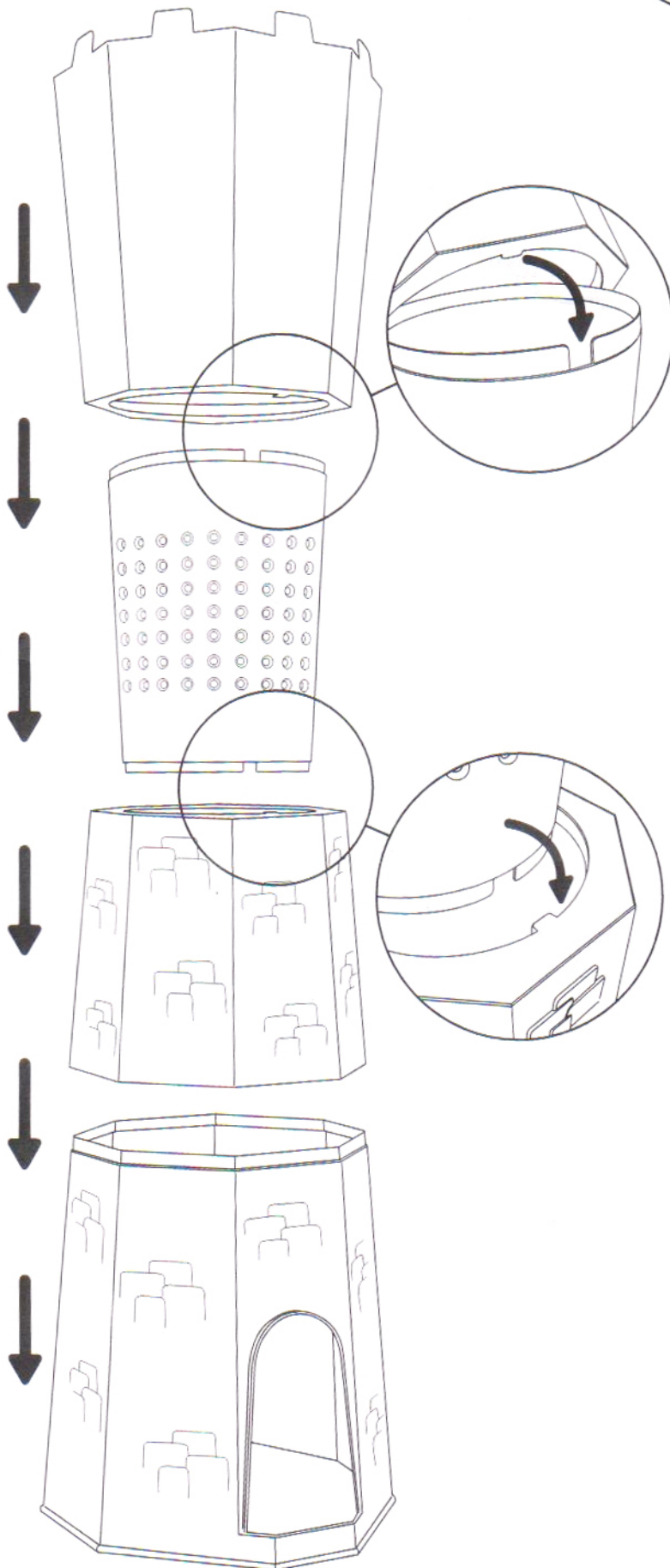

## List of Parts:



## Assembly Instructions:

Assemble the Cannonball Drop tower as shown in the diagram on the left. Then insert the straws through the holes in the transparent section pushing each straw in through one hole and out the opposite side through another hole. Do this for each straw randomly around the tower at different heights and angles to form a mesh inside the tower. Finally pour the balls into the tower from the top so that they rest on the straws inside.

## How to Play:

- 1) Set up the game as described above
- 2) Players take turns to pull out one straw at a time.
- 3) If any of the Cannonballs drop down to the bottom of the tower, the player must collect them
- 4) The player with the most balls at the end of the game once all the straws have been removed is the loser.

## Variations on the Game:

Players can choose a straw colour and then only remove a straw of that colour when it is their turn to play.

You can choose to give a forfeit whenever a player makes any of the balls drop through the tower.

Or, you can make the loser of the game the player who makes the last ball drop to the bottom of the tower, no matter how many balls they have made drop during the rest of the game.

**Suitable for 2-3 players**

**Age 6+**



*Please retain these details for future reference.*

*The game is intended to be assembled by an adult or under adult supervision.*

**Garden Games Ltd**  
Holly House, Pine Woods Road, Longworth, Oxfordshire  
OX13 5HG  
Tel +44 (0)1865 391060 Fax +44 (0)1865 392800